

# FORGED STAINLESS STEEL GLOBE VALVES - ANSI CLASS 150 ~ 800

## DESIGN DESCRIPTION:

- BOLTED BONNET
- O.S & Y

## APPLICABLE STANDARDS:

- DESIGN PER API 602
- SOCKET WELD AND THREADED END PER ANSI B16.11
- PIPE THREADS PER ANSI B1.20.1
- FLANGED END PER ANSI B16.5
- INSPECTON AND TEST PER API 598

## SOCKET WELD ENDS SCREWED ENDS FLANGED ENDS

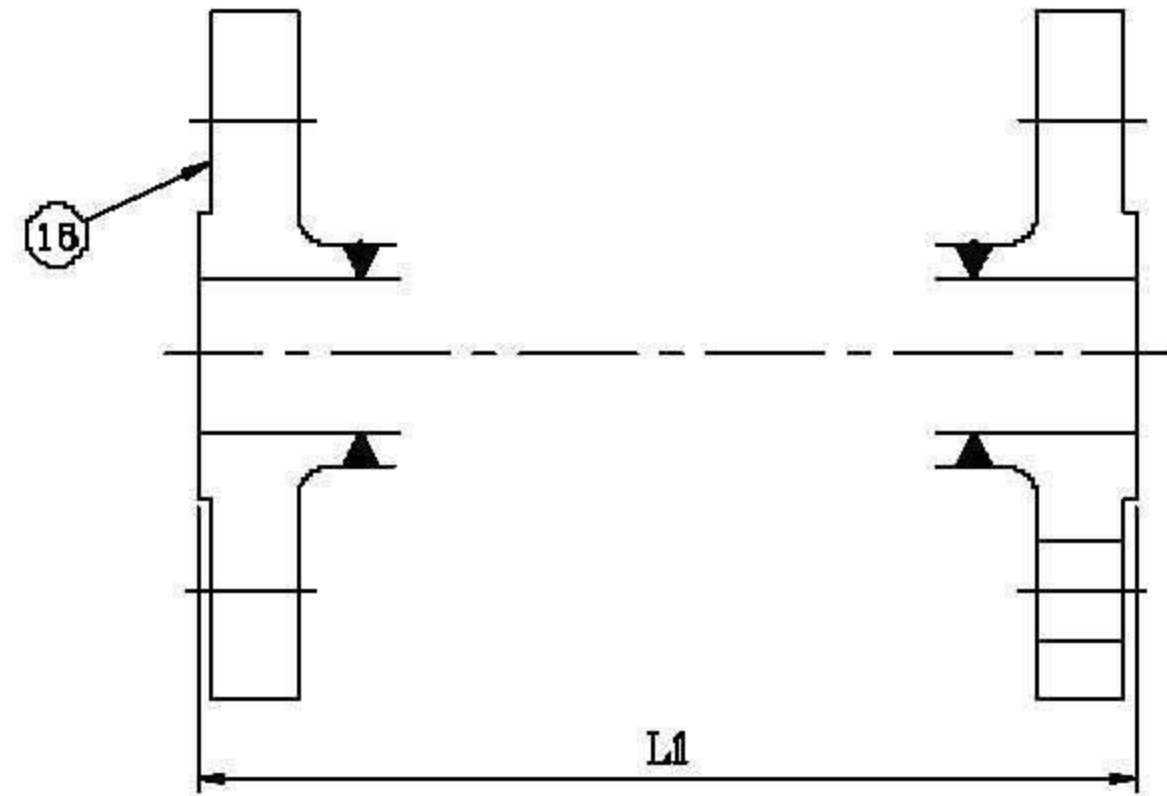

Flanged Ends

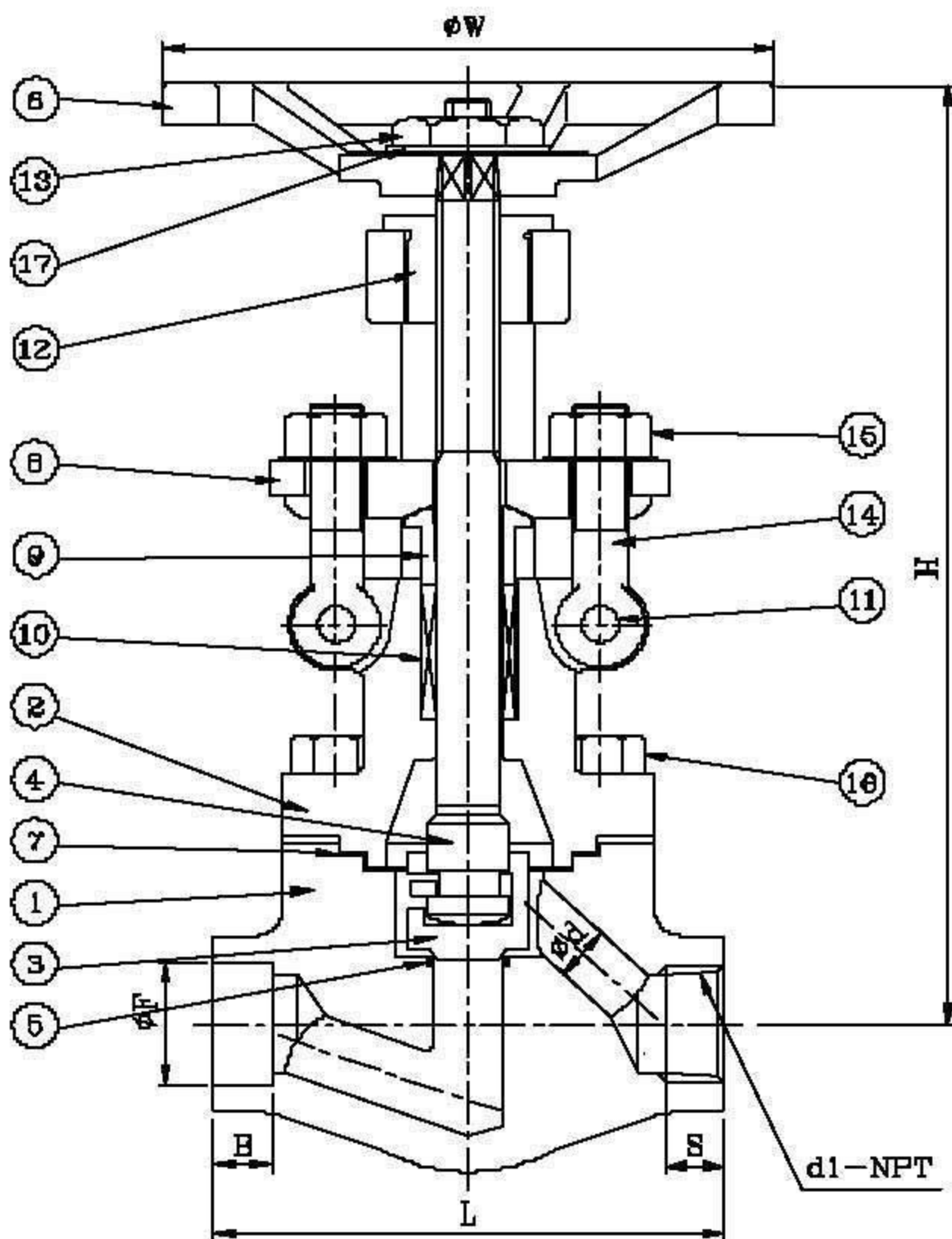

## TEST PRESSURE TO API 598

CLASS	SHELL TEST(water)	SEAT TEST(water)	SEAT TEST(air)
150	450 ( 32 kg/cm <sup>2</sup> )	314 ( 22 kg/cm <sup>2</sup> )	80 ( 6 kg/cm <sup>2</sup> )
300	1125 ( 79 kg/cm <sup>2</sup> )	814 ( 57 kg/cm <sup>2</sup> )	80 ( 6 kg/cm <sup>2</sup> )
600	2225 ( 156 kg/cm <sup>2</sup> )	1628 ( 114 kg/cm <sup>2</sup> )	80 ( 6 kg/cm <sup>2</sup> )
800	3000 ( 210 kg/cm <sup>2</sup> )	2200 ( 154 kg/cm <sup>2</sup> )	80 ( 6 kg/cm <sup>2</sup> )

PSIG

## PARTS AND MATERIAL (ASTM)

NO.	PARTS NAME	MATERIALS	
		A182-F304	A182-F316
1	Body	A182-F304	A182-F316
2	Bonnet	A182-F304	A182-F316
3	Disc	A276-304	A276-316
4	Stem	A276-304	A276-316
5	Seat	A276-304+H/F STL#6	A276-316+H/F STL#6
6	Hand Wheel	A47	
7	Gasket	Grafoil + 304 Spiralwound	Grafoil + 304 Spiralwound
8	Gland Flange	A182-F304	A182-F304
9	Gland	A276-304	A276-316
10	Gland Packing	Graphite	
11	Eye Bolt Pin	A276-304	
12	Stem Nut	A276-410	
13	Wheel Nut	A108-1020	
14	Eye Bolt	A193-B8	
15	Eye Bolt Nut	A194-8	A194-8
16	Bonnet Bolt	A193-B8	A193-B8
17	Name Plate	A666-304	
18	Flange	A182-F304	A182-F316

OTHER MATERIALS ARE AVAILABLE UPON REQUEST.

## DIMENSION TABLE:

DN	NPS	ø d	L	L1			H <sub>(OPEN)</sub>	ø W	SOCKET WELD		SCREWED		WT.(Kg) SW/NPT
				150#	300#	600#			øF	B	d1	S	
15	1/2	10	79	108	152	165	164	100	22	10	1/2" NPT	13.5	2
20	3/4	14	92	118	178	191	164	100	27	13	3/4" NPT	14.0	2.3
25	1	18	111	127	203	216	201	125	34	13	1" NPT	17.5	4.2
40	1 1/2	28	152	165	229	241	260	160	49	13	1 1/2" NPT	18.5	8.2
50	2	34	172	203	267	292	289	180	61	16	2" NPT	19.0	12.3